

Colourline, Silverline & Timberline

Contemporary, sophisticated and timeless solutions





Full height solid and single glazed Colourline incorporating bespoke manifestation film

Serenely subtle or boldly dynamic colours, high or wide design – whatever your style preference, make it reality with Colourline relocatable partitioning. Featuring pre-glazed windows and pre-decorated panels, no system could be more flexible or quicker and simpler to install. There is little or no snagging and no wet trades required on site. The wide spectrum of colours and versatile system options allow you to create your own environment at outstanding cost with Colourline.

Colourline

Contemporary character



Solid Colourline incorporating half height glazed windows and veneered doors



Door head height pre-assembled windows with venetian blinds and veneered doors



Silverline partitioning offers the uncompromising flair of sophisticated brushed steel. Free from intrusive covers and visible connections it opens a world of possibilities. There is a stunning choice of metallic paint finishes, plus doors in a range of handsome veneers. Together they lend the system impeccable refinement and panache. A durable powder coating in 6 standard colours can be applied to the aluminium skirting or joint trim. One look and you will marvel how the clean lines and stark simplicity of Silverline create a stylish office environment.



Glazed door in 75mm door frame with manifestation and pre-glazed Silverline window

Silverline

Sophisticated style



Full height Silverline windows with integral venetian blinds



Door head height pre-assembled windows with integrated venetian blinds and veneered doors



Timber veneer doors and full height windows with integral venetian blinds

Timberline

A timeless choice

Nothing exudes warmth and beauty better than natural wood. Here we've combined wood's valued aesthetics with the strength of steel, an office romance made in heaven. Timberline is constructed from high quality steel with a timber powder coated finish that's virtually impossible to distinguish from solid oak. Yet it's tougher, more resilient and considerably less expensive.

The window modules can be supplied as single or double glazed with integrated venetian blinds. The timber doors can be supplied with a choice of veneers and glazed door options.

For high impact with traditional charm, it must be Timberline.



Oak veneered doors



Timberline door frame and window detail



Ironmongery

Romstor Door Furniture



Robar



Hewi



Wave

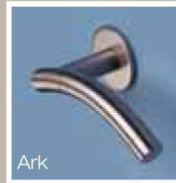

Ark



Linum

Romstor can supply a range of ironmongery including levers, handles, hinges and locks to suit client requirements. Please contact us for further information.

Veneers

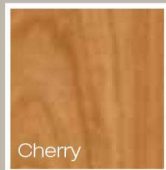

Cherry



Crown Cut Ash



Koto



Maple



Sapele

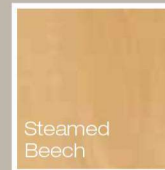

Steamed
Beech



White Oak

Colours

Colourline

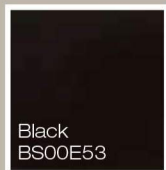

Black
BS00E53



Blue
RAL5017



Brown
RAL8019



Burgundy
RAL3004



Crocus Delux
CD 2020-R80B



Granite
BS00A05

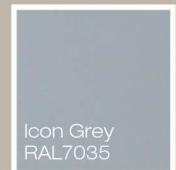

Icon Grey
RAL7035

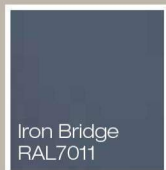

Iron Bridge
RAL7011



Pine Green
RAL6028



Sand
BS08B17



Sapphire
RAL5003



White
BS00E55

Silverline

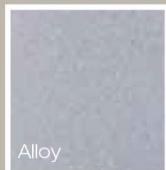

Alloy



Bronze



Charcoal



Gold Dust



Midnight Blue



Patina
Chrome

Timberline



Cherry Oak



Honey Maple



Montana Oak



Teak



Whilst every effort has been made to ensure that colours and veneers shown are as accurate a representation as can be achieved, there may be differences between the actual product and the illustrations shown as a result of the printing process. Physical samples can be provided on request.

Colourline, Silverline & Timberline

Technical Data

Colourline, Silverline and Timberline are designed for rapid installation, minimum site working and high fire resistance and acoustic performance. A framework of steel studs clad with plasterboard is used for solid modules combined with factory manufactured steel framed door and pre-glazed window units. The products are available in three versions: Colourline in standard RAL and BS colours, Silverline in metallic colour finishes and Timberline in a replicated wood veneer.

STRUCTURE

Partitions:

Standard Heights: 2.4 metres, 2.7 metres and 3.0 metres.

Tracks: Polyester powder coated steel to DC01 at EN10.130 specification.

Corners: Steel pre-manufactured with pre formed 90°, 135° and radius corners for head tracks.

Dimensions: Nominal 75mm across panel faces, 85mm across tracks and trims and 50mm deep deflection head available. Overall thickness of the systems is either 75mm or 100mm.

Glass: 6mm toughened or 16.8mm fire rated insulating glass for FR30/30 and FR60/30.

Joints: Top hat trims, contour trims, flush wall and tape and fill detail.

Inter module trims: Colour co-ordinated PVC, aluminium or steel top hat sections.

Blinds: Single offset glazed with blinds and wands. Double glazed with internal 25mm manually controlled tilt and turn venetian blinds.

DOOR SETS

Options: Glass, timber, double glazed GDS and sliding doors complement Colourline, Silverline and Timberline systems.

Solid doors: Timber doors are either 44mm or 54mm solid core in a choice of veneers.

Door frames: Steel and are either full height or universal standard height. Single, double & hospital door sets are available.

A range of ironmongery can be supplied with Colourline, Silverline and Timberline doors.

FINISHES

All exposed steel sections are pre-finished with a polyester powder coating in a range of RAL colours.

SIZE LIMITS

Colourline, Silverline and Timberline are designed for installation in areas up to 4.5 metres high with boxed studs.

ASSEMBLY CHARACTERISTICS

The solid modules are constructed from an inner framework of steel sections clad with undecorated or pre-decorated plasterboards. The glazed modules are steel framed and pre-manufactured in single or double glazed versions. The door modules are pre-manufactured steel frames complete with doors in different veneers. Door modules are 2.1 metres high as standard or alternatively full height or with matching overpanels.

PERFORMANCE

Fire resistance: FR30/0, FR60/0 and FR60/30 to BS476 part 22.

Sound reduction: BS EN ISO 140; Rated weighting to BS EN ISO 717.

Acoustics: Solid 75mm up to 43Rw(dB), solid 100mm up to 50Rw(dB) and double glazed up to 35Rw(dB).

Structural: BS5234, BS6180 and BS6399. Commercial office (BS medium duty).



Colourline, Silverline & Timberline are designed and manufactured in the UK.



Romstor Ltd

Unit 22F West Station Industrial Estate,
Spital Road, Maldon, Essex, CM9 6TS

Tel: 01621 855 600

Freephone: 0800 328 4908

Email: sales@romstor.co.uk

www.romstorprojects.co.uk

Colourline, Silverline & Timberline

Sectional Drawings

Please note: All illustrations shown here depict Silverline. For further information or technical drawings for Colourline and Timberline please contact the Apton technical department.

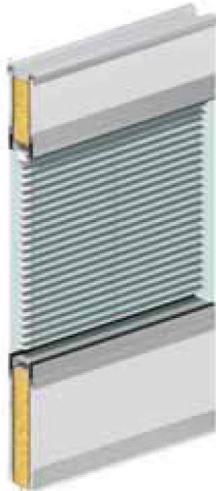

Part double glazed vertical section
with integral venetian blinds



Double glazed vertical section



Door frame vertical section



Door jamb



Double glazed mullion

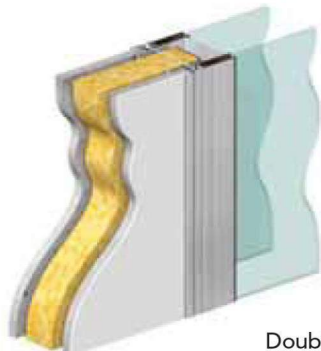
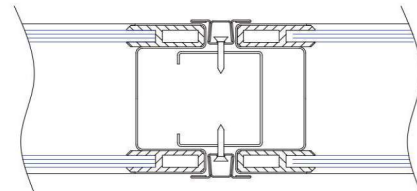
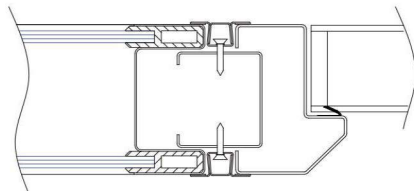

Double glazed to solid mullion

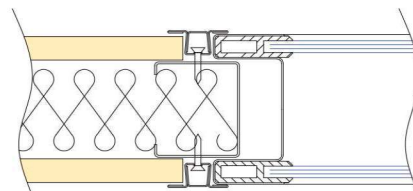



Romstor Ltd

Unit 22F West Station Industrial Estate,
Spital Road, Maldon, Essex, CM9 6TS

Tel: 01621 855 600

Freephone: 0800 328 4908

Email: sales@romstor.co.uk

www.romstorprojects.co.uk

Mezzanine Floors • Partitioning • Shelving • Racking • Workplace Equipment

Colourline, Silverline & Timberline

Contemporary, sophisticated and timeless solutions